

## THE POPLAR Elevation - C



Width 28'-0" Depth 41'-0"

### SQUARE FOOTAGE

#### HEATED

FIRST FLOOR	720 SQ.FT.
SECOND FLOOR	845 SQ.FT.
TOTAL	1,565 SQ. FT.

#### UNHEATED

FRONT PORCH	77 SQ.FT.
GARAGE	230 SQ.FT.
REAR PORCH	58 SQ.FT.
TOTAL	365 SQ.FT.

NOTE: Foundation, Elevation, Dimensions, Finishes and Floor Plan may be modified by Builder without notice.

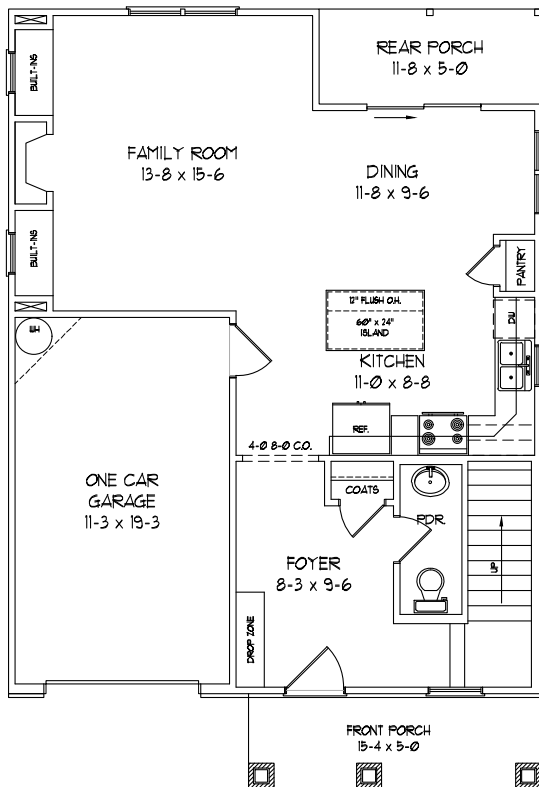

**FIRST FLOOR**

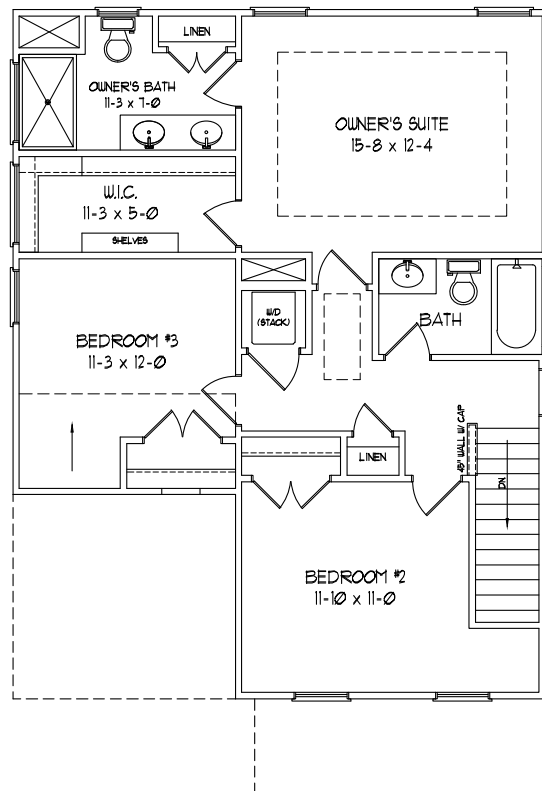

**SECOND FLOOR**