

WEAVER

HOMES

910.630.2100 ■ 919.606.4696

350 Wagoner Drive, Fayetteville, NC 28303

1362 Lindsay - A

150239B



FRONT ELEVATION

Width 38 Depth 57
SQUARE FOOTAGE

HEATED

FIRST FLOOR 1362 SQ.FT.
TOTAL 1362 SQ.FT.

UNHEATED

GARAGE 442 SQ.FT.
FRONT PORCH 141 SQ.FT.
PATIO / SP 104 SQ.FT.
TOTAL 687 SQ.FT.

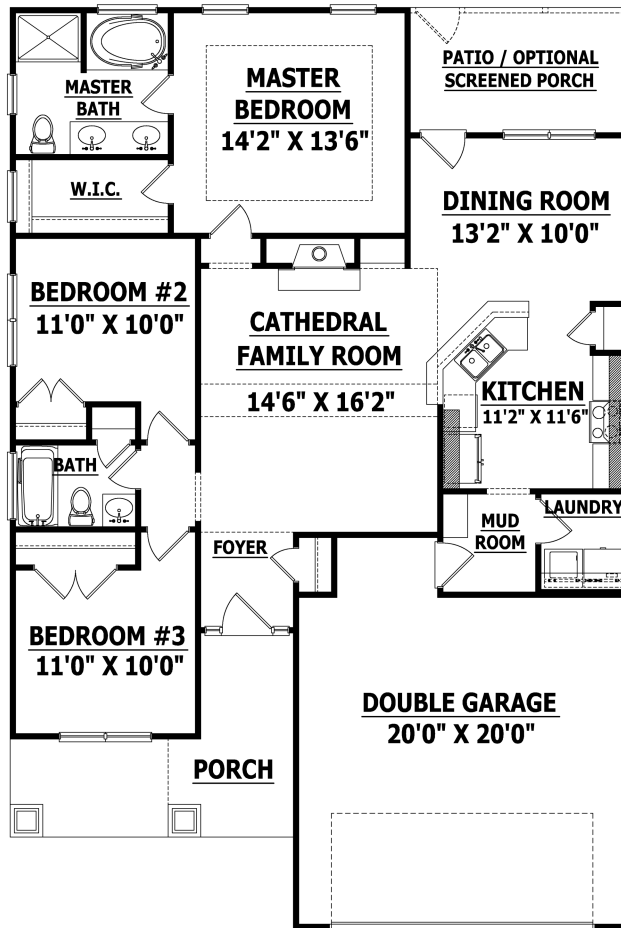

FIRST FLOOR

Copyright © 2015 Haynes Home Plans, Inc.

350 Wagoner Drive, Fayetteville, NC 28303 910-630-2100