

WEAVER

HOMES

910.630.2100 ■ 919.606.4696

350 Wagoner Drive, Fayetteville, NC 28303

Lindsay - A

130117B



FRONT ELEVATION

Width: 41 Depth: 62

SQUARE FOOTAGE

HEATED

FIRST FLOOR 1638 SQ.FT.
TOTAL 1638 SQ.FT.

UNHEATED

GARAGE 438 SQ.FT.
FRONT PORCH 169 SQ.FT.
PATIO / SP 144 SQ.FT.
TOTAL 751 SQ.FT.

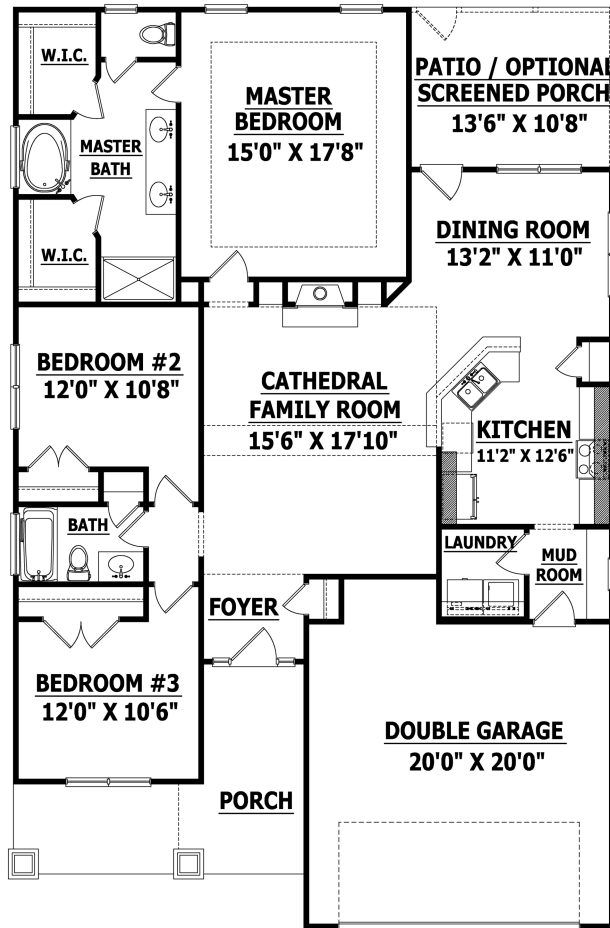

FIRST FLOOR

Copyright © 2013 Haynes Home Plans, Inc.

350 Wagoner Drive, Fayetteville, NC 28303 910-630-2100